

COLLECTOR STREETS STRUCTURE
N.T.S.

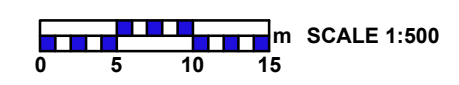
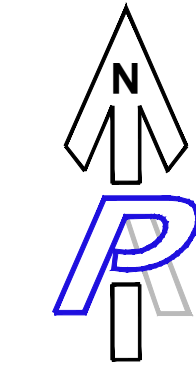
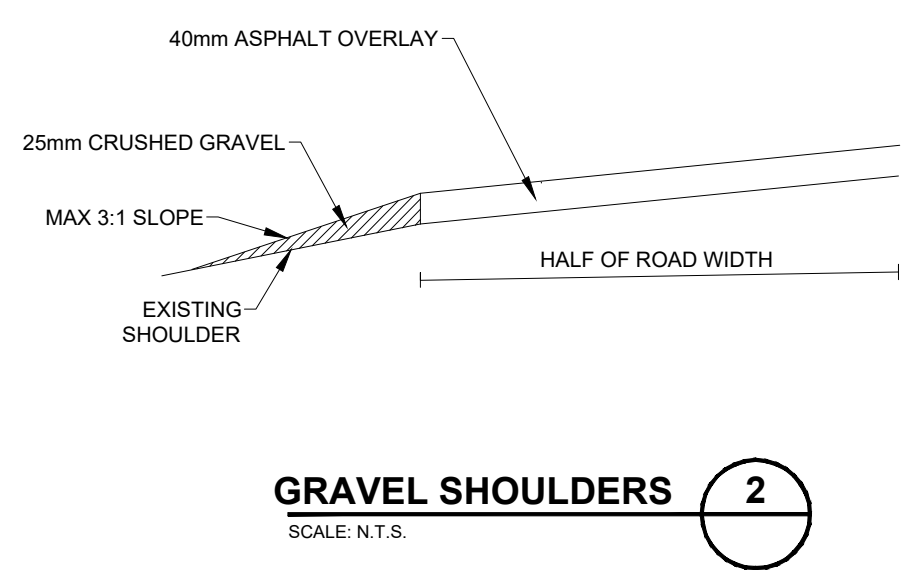
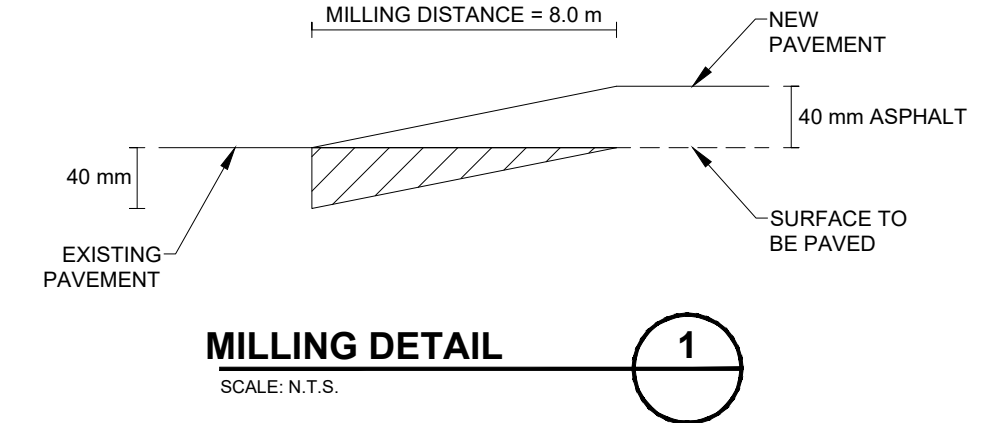
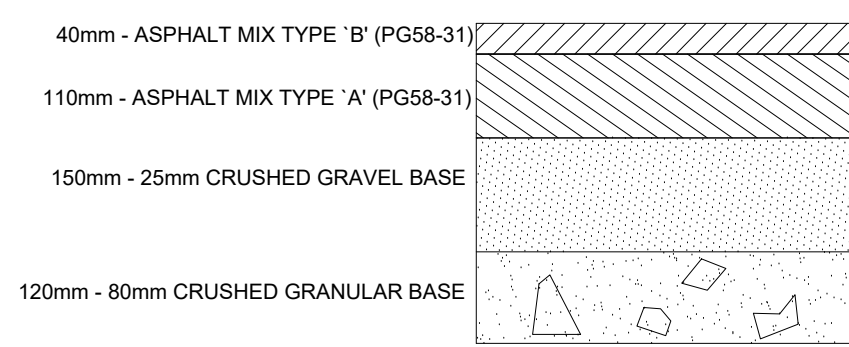

NOTES

- ALL SPECIFICATIONS ARE CURRENT TOWN OF OKOTOKS.
- ALL RADII REFER TO LIP OF GUTTER UNLESS OTHERWISE NOTED.
- 25mm CRUSHED GRAVEL IS PLACED ALONG THE EXISTING SHOULDER, TYING IN THE ORIGINAL GROUND SURFACE TO THE 40mm OVERLAY. SEE DETAIL 2 ON SHEET 00-001A.

LEGEND

---	CONSTRUCTION BOUNDARY
R	ROLLED CURB & 0.25m GUTTER UNLESS OTHERWISE SPECIFIED
STD	STANDARD CURB & 0.25m GUTTER UNLESS SPECIFIED
PROPOSED EXISTING	MONOLITHIC ROLLED CURB & 0.25m GUTTER AND WALK (WIDTH AS SPECIFIED)
PROPOSED EXISTING	SEPARATE WALK (WIDTH AS SPECIFIED)
□	TYPE 'C' OR 'K-2' CATCH BASIN, SINGLE BARREL, 250mm LEAD UNLESS OTHERWISE NOTED
□	CATCH BASIN - EXISTING AND/OR APPROVED
▲	WHEEL CHAIR RAMP
▨	LEVEL COURSE AS REQUIRED AND PLACE 40mm MIX TYPE B (PG58-31) AS PER PAVEMENT DESIGN
---	AREA 1 BOUNDARY
---	AREA 2 BOUNDARY

DISCLAIMER
This drawing has been produced for the use of Pasquini & Associates Consulting's client and may not be reproduced or relied upon by third parties except where agreed upon by Pasquini & Associates Consulting Ltd. and its client. Pasquini & Associates Consulting Ltd. accepts no responsibility or liability whatsoever to any party that modifies this drawing without written consent from Pasquini & Associates Consulting Ltd.

Do not scale this document. All measurements must be obtained from stated dimensions.

ISSUE	DATE	ISSUE/REV DESCRIPTION	DRN	CHK	DES	ENG	IDR	APP
A	24/02/26	Issued for Preliminary Submission	DD		DD	TJD	TJD	DP

PROFESSIONAL SEALS

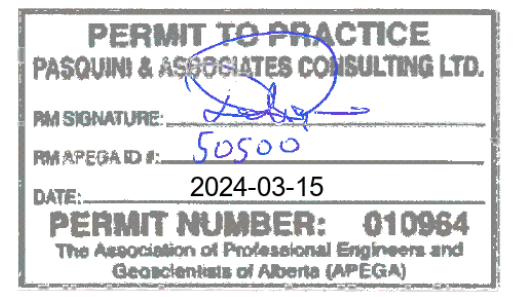
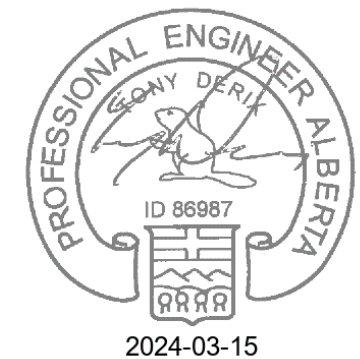

Town of Okotoks

Transportation Paving Program 48th ST

Sidewalk and Roads Layout

FILE NUMBER 286-020	SHEET 00-001A	REV / ISSUE A
------------------------	------------------	------------------

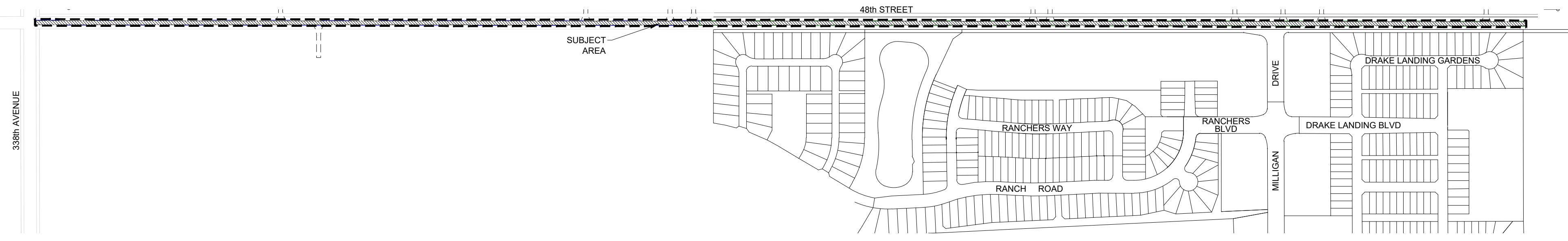

KEY PLAN

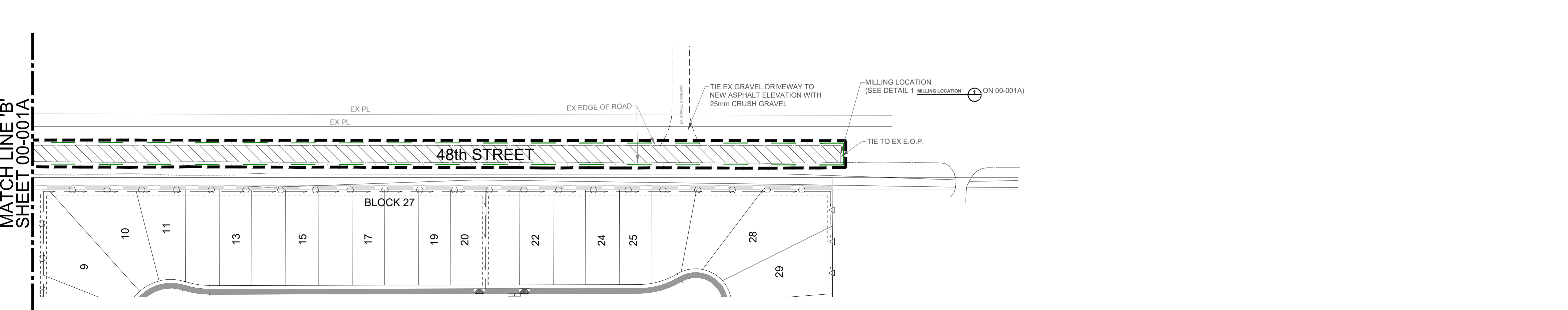
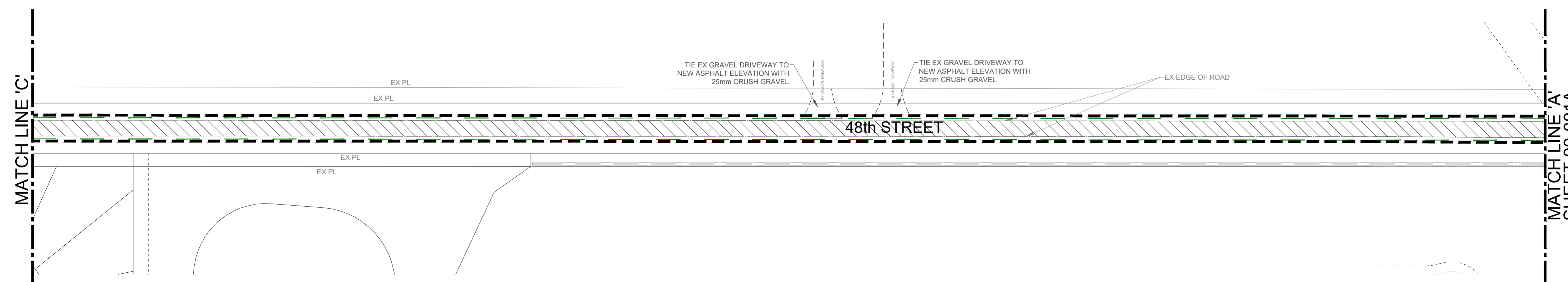
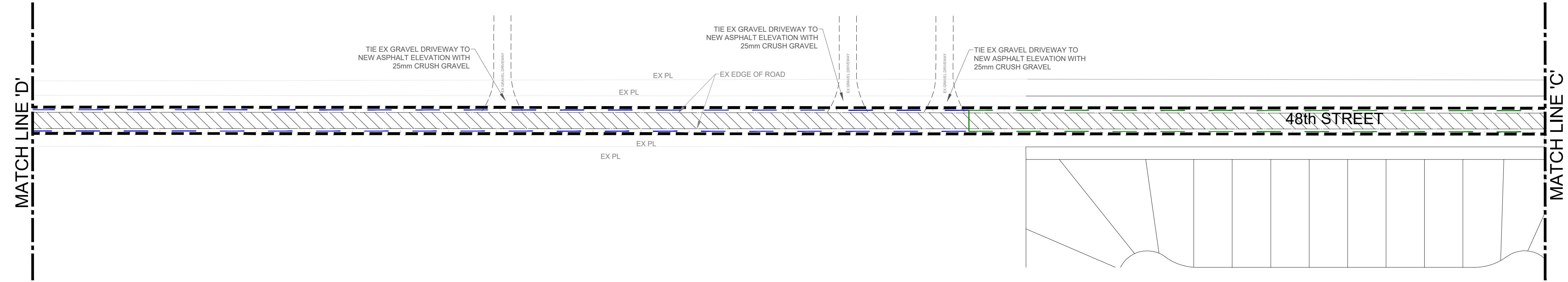
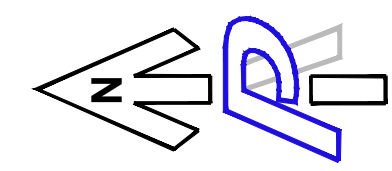

NOTES

- ALL SPECIFICATIONS ARE CURRENT TOWN OF OKOTOKS.
- 1. ALL RADII REFER TO LIP OF GUTTER UNLESS OTHERWISE NOTED.
- 2. 25mm CRUSHED GRAVEL IS PLACED ALONG THE EXISTING SHOULDER, TYING IN THE ORIGINAL GROUND SURFACE TO THE 40mm OVERLAY. SEE DETAIL 2 ON SHEET 00-001A.

LEGEND

	CONSTRUCTION BOUNDARY
	ROLLED CURB & 0.25m GUTTER UNLESS OTHERWISE SPECIFIED
	STANDARD CURB & 0.25m GUTTER UNLESS SPECIFIED
	MONOLITHIC ROLLED CURB & 0.25m GUTTER AND WALK (WIDTH AS SPECIFIED)
	SEPARATE WALK (WIDTH AS SPECIFIED)
	TYPE 'C' OR 'K-2' CATCH BASIN, SINGLE BARREL, 250mm LEAD UNLESS OTHERWISE NOTED
	CATCH BASIN - EXISTING AND/OR APPROVED
	WHEEL CHAIR RAMP
	LEVEL COURSE AS REQUIRED AND PLACE 40mm MIX TYPE B (PG58-31) AS PER PAVEMENT DESIGN
	AREA 1 BOUNDARY
	AREA 2 BOUNDARY

DISCLAIMER
 This drawing has been produced for the use of Pasquini & Associates Consulting's client and may not be reproduced or relied upon by third parties except where agreed upon by Pasquini & Associates Consulting Ltd. and its client. Pasquini & Associates Consulting Ltd. accepts no responsibility or liability whatsoever to any party that modifies this drawing without written consent from Pasquini & Associates Consulting Ltd.
 Do not scale this document. All measurements must be obtained from stated dimensions.

ISSUE	DATE	ISSUE/REV DESCRIPTION	DRN	CHK	DES	ENG	IDR	APP
A	24/02/26	Issued for Preliminary Submission	DD		DD	TJD	TJD	DP

PROFESSIONAL SEALS

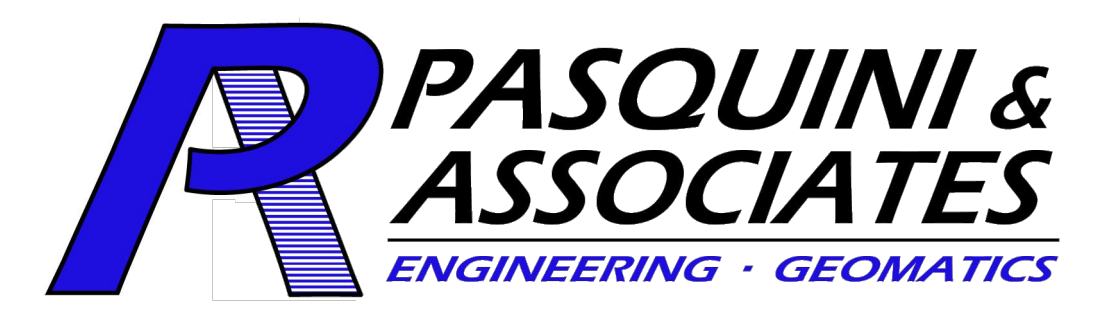
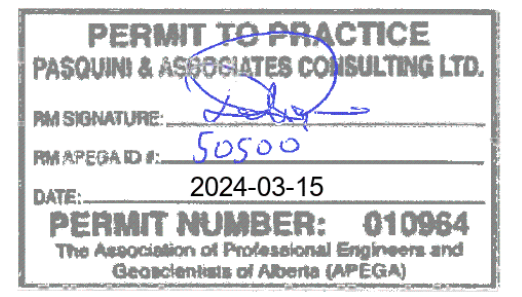
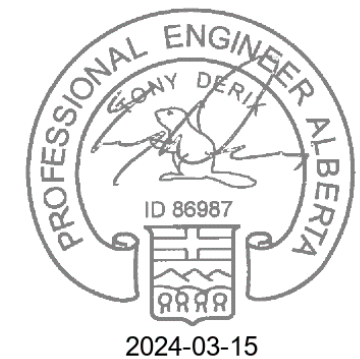

Town of Okotoks
 Transportation Paving Program 48th ST
 Sidewalk and Roads Layout

FILE NUMBER	286-020	SHEET	00-001B	REV / ISSUE	A
-------------	---------	-------	---------	-------------	---

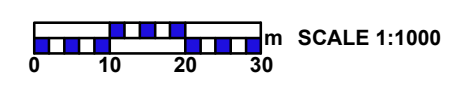

SIZE: ANSI D (22.00 x 34.00 inches)

DATE: 2/26/2024 9:45:19 AM

PLOT: Dhwanit Dabhatwala

FILE NAME: 286-020_00-001 - Copy - 1.dwg

SIZE: ANSI full bleed D (22.00 x 34.00 inches)

DATE: 2/26/2024 9:46:55 AM

PLOT: Dhawan Daibhatwala

FILE NAME: 286-02_00-001 - Copy - 1.dwg

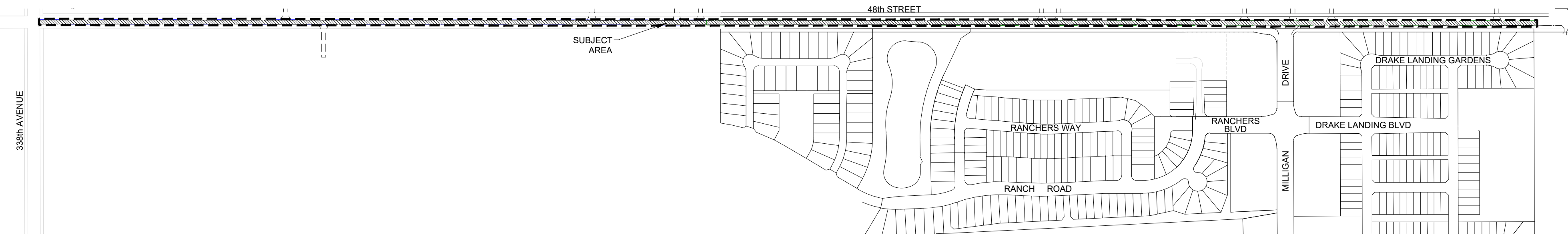

KEY PLAN

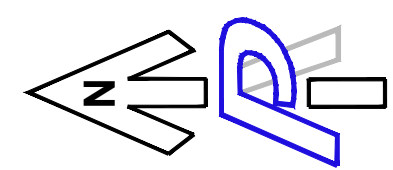

NOTES

- ALL SPECIFICATIONS ARE CURRENT TOWN OF OKOTOKS.
- 1. ALL RADII REFER TO LIP OF GUTTER UNLESS OTHERWISE NOTED.
- 2. 25mm CRUSHED GRAVEL IS PLACED ALONG THE EXISTING SHOULDER, TYING IN THE ORIGINAL GROUND SURFACE TO THE 40mm OVERLAY. SEE DETAIL 2 ON SHEET 00-001A.

LEGEND

- CONSTRUCTION BOUNDARY
- R ROLLED CURB & 0.25m GUTTER UNLESS OTHERWISE SPECIFIED
- STD STANDARD CURB & 0.25m GUTTER UNLESS SPECIFIED
- PROPOSED EXISTING MONOLITHIC ROLLED CURB & 0.25m GUTTER AND WALK (WIDTH AS SPECIFIED)
- PROPOSED EXISTING SEPARATE WALK (WIDTH AS SPECIFIED)
- TWIN TWIN TYPE 'C' OR 'K-2' CATCH BASIN, SINGLE BARREL, 250mm LEAD UNLESS OTHERWISE NOTED
- TWIN TWIN CATCH BASIN - EXISTING AND/OR APPROVED
- WHEEL CHAIR RAMP
- LEVEL COURSE AS REQUIRED AND PLACE 40mm MIX TYPE B (PG58-31) AS PER PAVEMENT DESIGN
- AREA 1 BOUNDARY
- AREA 2 BOUNDARY

DISCLAIMER
 This drawing has been produced for the use of Pasquini & Associates Consulting's client and may not be reproduced or relied upon by third parties except where agreed upon by Pasquini & Associates Consulting Ltd. and its client. Pasquini & Associates Consulting Ltd. accepts no responsibility or liability whatsoever to any party that modifies this drawing without written consent from Pasquini & Associates Consulting Ltd.

Do not scale this document. All measurements must be obtained from stated dimensions.

ISSUE	DATE	ISSUE/REV DESCRIPTION	DRN	CHK	DES	ENG	IDR	APP
A	24/02/26	Issued for Preliminary Submission	DD		DD	TJD	TJD	DP

PROFESSIONAL SEALS

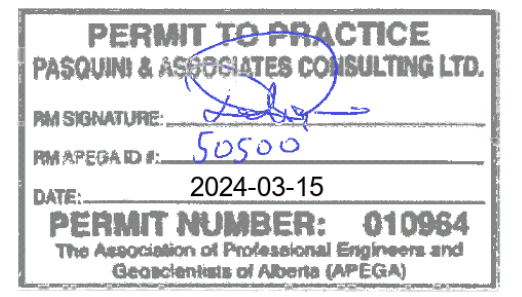
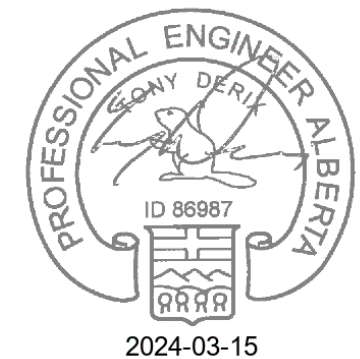

Town of Okotoks
 Transportation Paving Program 48th ST

Sidewalk and Roads Layout

FILE NUMBER	286-020	SHEET	00-001C	REV / ISSUE	A
-------------	---------	-------	---------	-------------	---

